



NORMAN Lamps, Inc.

Aircraft Lamp Division

Serving the Aviation Industry Since 1985

Design • Manufacturing • Distribution

- Aircraft Landing Light
- 4553; NSN 6240-00-816-4808; MS25241-4553

GENERAL SPECIFICATIONS

Lamp Type	Sealed Beam-PAR
Bulb	PAR46
Base	Screw Terminals
Filament	CC-8, Shielded
Voltage	28
Wattage	250
Rated Life	25 Hrs.
Primary Application	Aircraft

PHYSICAL SPECIFICATIONS

Maximum Overall Length	3.12" (79mm)
Maximum Bulb Diameter	5.67" (144.0mm)
Bulb Edge Width	0.39" (10.0mm)

NLI
4553 28V 250W
AIRCRAFT LANDING

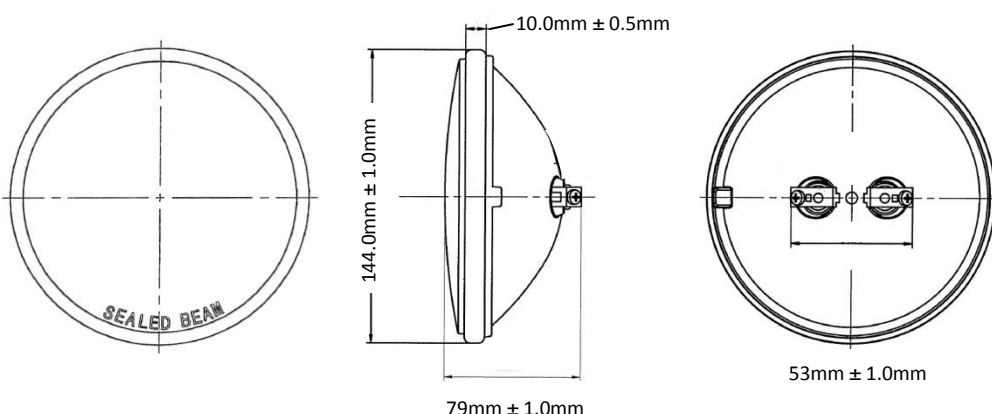

PACKAGING, WEIGHTS & DIMENSIONS

Master Carton	24 Lamps	24Lbs.	31"x13"x10"
Inner pack	12 Lamps	11Lbs.	15"x12"x9"
Unit Pack	1 Lamp	14oz.	5"x4½"x6"

SPECIAL FEATURES

- Solid Brass Screw Base
- Secure Locking Washer
- Heavy Duty, Shielded Filament Structure
- Vibration Resistant
- Computer Aligned Filament Positioning
- Double Layer Aluminum Reflector

NORMAN LAMPS, INC. (NLI)

Every NLI aircraft lamp is manufactured to exacting industry and military specifications. Physical, electrical and optical specifications and tolerances meet these standards. NLI certifies all aircraft lamps we manufacture to be free from any and all manufacturing and specification defects. Each NLI aircraft lamp is pre-tested and fully inspected before they are made available for distribution. For additional information visit: www.AircraftLightingDirect.com NLI/2011