



Catalog Number	
Notes	Type

FEATURES

The Analog Photosensor is an ambient light sensing device that connects to a Synergy™ panel, Synergy remote station, or SwitchPak™ lighting control panel as an analog input. The photosensor provides control of lighting in response to ambient light conditions.

- Indoor and outdoor applications
- Color compensated to provide accurate readings
- Easy mounting
- Class-2 wiring
- Linear response curve
- Multiple set-points from a single photocell when used with Synergy or SwitchPak panels
- Daylight-compensating or daylight-tracking operation
- Switch or dim loads

System Accessories

LSA APS

ANALOG PHOTONSENSOR

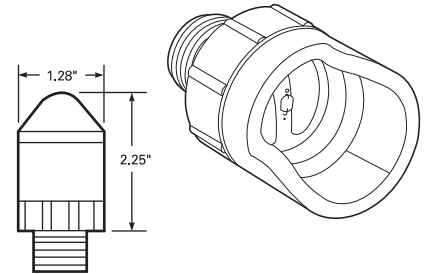

ORDERING INFORMATION

Example: **LSA APS OL**

Choose the boldface catalog nomenclature that best suits your needs and write it on the appropriate line. Order accessories as separate catalog number.

LSA		APS			
Series		Photosensor		Mounting type	
LSA	Lithonia System Accessory	APS	Analog photosensor	OL	Outdoor (0-100 FC)
				S	Skylight/atrium (0-10,000 FC)

LSA APS Analog Photosensor

SPECIFICATIONS

MECHANICAL

- Indoor Sensor – Mounts to accessible ceiling with supplied adhesive backing, within 6-8 feet of windows, central to the area being controlled. Optional canopy mounts to 4" square box by others.
- Outdoor Sensor – Integral ½" ID threaded fitting mounts to standard ½" conduit opening; locate on roof or other exposed structure that is not shaded or exposed to night time illumination.
- Skylight/Atrium Sensor – Integral ½" ID threaded fitting mounts to standard ½" conduit opening; mount in atrium facing upward near the glazing as far out from the wall as possible. In skylight applications, mount facing upward near center of skylight away from shadows.

CONSTRUCTION

- Material – Cylolact™ UV stabilized plastic.
- Color – White.
- Type – Blue enabled photo-diode.

ENVIRONMENTAL

- Operating Temperature: 13-140°F (11-60°C).

DIMENSIONS

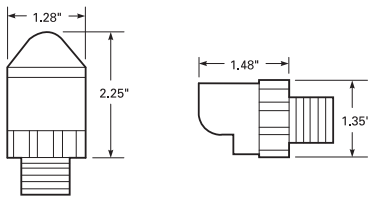

Skylight/Atrium

Outdoor

WIRING DIAGRAM

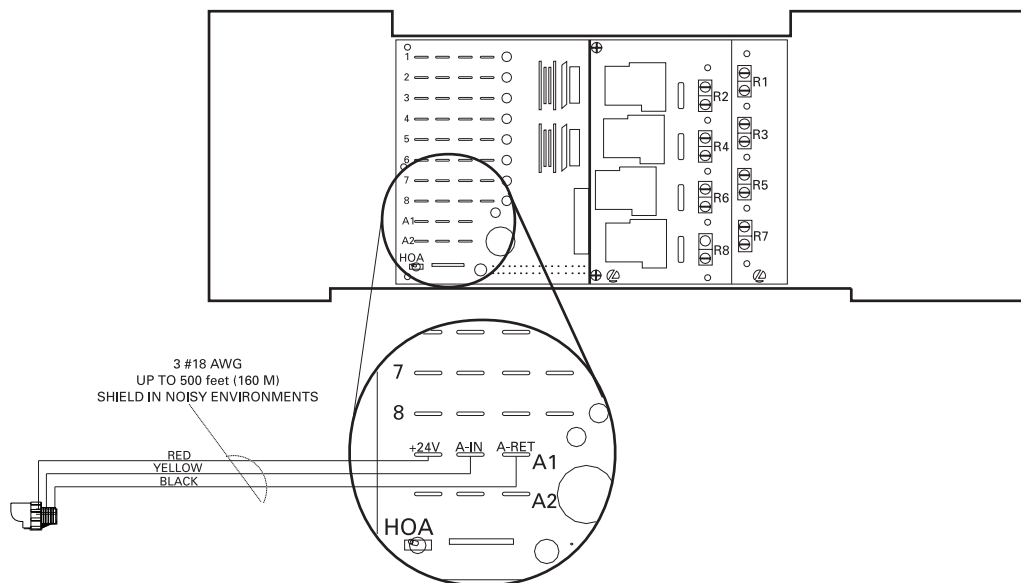

FUNCTIONAL

- Response – Linear to ambient light level over entire range. Single set point with deadband to prevent cycling or linked to outputs for multi-step or variable response; transmit up to 100 steps onto Synergy network.
- Field of View:
Indoor Sensor – 60° Fresnel lens minimizes effects of stray light.
Outdoor Sensor – Omni-directional with hooded aperture to shield sensor from direct light, epoxy encapsulated to seal out moisture.
Skylight/Atrium Sensor – 180° field of view with dome diffuser.

ELECTRICAL

- Accuracy – +/- 1% at 70°F (21°C)
- Input Voltage – 24 VDC, Class 2, supplied by Synergy power module, 3 conductor #18 AWG.
- Output Range: (see chart below)
Outdoor – 0-100 Fc = 0-10 VDC
Outdoor – 0-1000 Fc = 0-10 VDC
Skylight/Atrium – 0-10,000 Fc = 0-10 VDC

OUTPUT RANGE CHART

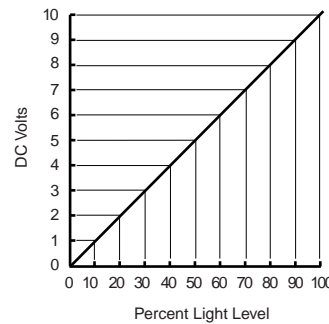

An Acuity Brands Company