

DWG NO. 1000675 BH1

REVISIONS			
REV	DESCRIPTION	DATE	APPROVED

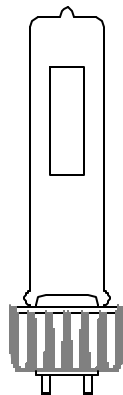
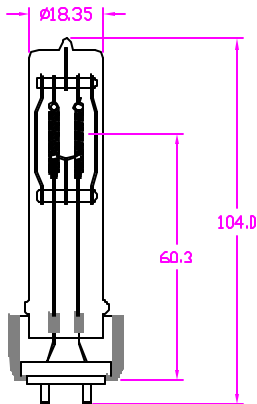
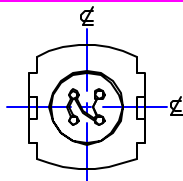

NOTES

1. ALL DIMENSIONS ARE IN MM UNLESS OTHERWISE SPECIFIED.
2. SEAL TEMP SHOULD BE MAINTAINED BELOW 300°C.
3. THE DIMENSIONS AND SPECIFICATIONS OF PRODUCT LISTED IN THIS SHEET ARE SUBJECT TO CHANGE WITHOUT NOTICE FOR IMPROVEMENT.

CHARACTERISTICS	
VOLTAGE	115 V
WATTAGE	750 W
COLOR TEMP	3250 K
LUMENS	21900 Lm
FILAMENT	4-C8
AVERAGE LIFE	300 HRS
BASE	HEAT SINK
BURNING POSITION	ANY

NEXT ASSY USED ON APPLICATION

ITEM	QTY	DESCRIPTION	CODE IDENT	PART NUMBER	REMARKS	
LIST OF MATERIALS						
UNLESS OTHERWISE SPECIFIED DIMENSIONS ARE IN INCHES		CONTRACT NO.		USHIO AMERICA, INC. 5440 Carritas Ave. Cypress, CA 90830 TITLE HPL-750/115V, JS115V-750WC HALOGEN LAMP		
DECIMALS .X ± -		APPROVALS				DATE
.XX ±		DRAWN				05/15/01
.XXX ±		ENGR				05/15/01
ANGLES		MFG				
DRILLED HOLES PER AND 10387		QUAL				
REMOVE BURRS AND SHARP EDGES		DRON ACTVY				
ALL DIMENSIONS AFTER PLATING		DVTY ACTVY				
MATERIAL		FINISH		SIZE B DODE IDENT NO. DWG NO. 1000675		
COMPOSITE				SCALE NONE WEIGHT SHEET 1 OF 1		