

SYLVANIA Luminaires

Area Light

Application

The Area Light luminaires are the perfect alternative to traditional lighting technologies offering a variety of solutions to illuminate parking lots, parking garage roofs and general area lighting.

Benefits and Features

- Integrated photocontrol receptacle compatible with up to 7 pin photosensors. Shorting Cap is included.
- Slim design with multiple mounting and distribution options
- Robust fixture with IP66 and 3G Vibration rating
- Up to 130 LPW
- 4000K and 5000K color temperature
- CRI 80+
- Offered in 70, 110, 145 and 220 watts
- Type III, IV, V distribution
- Energy savings up to 74%
- UV stabilized polycarbonate lens

Electrical

- 120-277 V_{AC} or 347-480 V_{AC} options
- Power factor $\geq 90\%$
- THD $\leq 20\%$
- 0-10V dimmable
- Constant current LED driver with 4kV surge suppression

Rated Life

- $\geq 140,000$ hours (L₇₀)

Warranty

- Standard 5-year luminaire warranty (LEDLUM001)
- Limited 10-year luminaire warranty (LEDLUM003)

Ambient Operating Range

- -40°F to +104°F (-40°C to +40°C)

Certifications and Listings

- cULus listed to UL1598 standards for wet locations and IP66 rated
- Driver meets UL1310 and UL48 Class I

Item #

Type

Project

Notes

Date



Wattage Comparison

Traditional Source	Traditional System Wattage	LED System Wattage	Energy Savings
100W HPS	120	70	42%
100W MH	130	70	46%
150W HPS	170	70	59%
150W MH	188	70	63%
175W MH	210	70	67%
175W MH	210	110	48%
250W HPS	295	110	63%
250W MH	290	110	62%
250W HPS	295	145	51%
250W MH	290	145	50%
320W MH	370	145	61%
400W HPS	460	145	68%
400W MH	450	145	68%
750W MH	820	220	73%
750W HPS	840	220	74%

Installation

- Fixture mounting options include: square pole, round pole, wall mount, trunnion mounting, or slip fitter mount for 2-1/8" to 2-3/8" tenon. Flood light mounting up to 45° angle. Do not mount lens facing upwards. Mounting accessories sold separately.



Physical Information

Lamp Description	(A) Length	(B) Width	(C) Height
70W	12.2 in (309.8 mm)	12.5 in (318 mm)	4.3 in (108.5 mm)
100/145W	15.2 in (386 mm)	12.5 in (318 mm)	4.3 in (108.5 mm)
220W	20.9 in (530.9 mm)	12.5 in (318 mm)	4.3 in (108.5 mm)

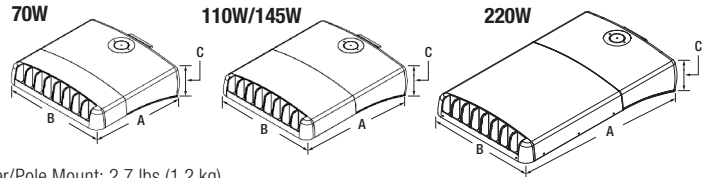

Weight: 70W: 9.7 lbs (4.4 kg) 110/145W: 11.5 lbs (5.2 kg) 220W: 18.5 lbs (8.4 kg) Slip Fitter/Pole Mount: 2.7 lbs (1.2 kg)

EPA (Effective Projected Area): 70W: Pole Mount 0.32ft², Slip Fitter 0.90ft² 110/145W: Pole Mount 0.46ft², Slip Fitter 1.12ft² 220W: Pole Mount 0.79ft², Slip Fitter 1.54ft²

Mounting Accessories

Item Number	Ordering Abbreviation	Item Description
71734	AREAFLD1A/SLIPFITTER/BZ	Slip Fitter Mount, Bronze
60130	AREAFLD1A/WALLTENON/BZ	Wall Tenon Mount, Bronze (Requires Slip Fitter)
71733	AREAFLD1A/POLEMOUNT/BZ	Pole Mount, Bronze
60128	AREAFLD1A/RNDADAPT/BZ	Round Adapter, Bronze (Requires Pole Mount)
60129	AREAFLD1A/WALLMNT/BZ	Wall Mount, Bronze (Requires Pole Mount)
60165	AREAFLD1ATRUNNION/BZ	Trunnion, Bronze
60163	AREAFLD1AVISOR01/BZ	Visor, Bronze, 70W
60164	AREAFLD1AVISOR02/BZ	Visor, Bronze, 110/145W
60650	AREAFLD1A/POLEMOUNT/WH	Pole Mount, White
60651	AREAFLD1A/SLIPFITTER/WH	Slip Fitter Mount, White
60652	AREAFLD1A/WALLMNT/WH	Wall Mount, White (Requires Pole Mount)

Visor

60163

60164

Trunnion (60165)

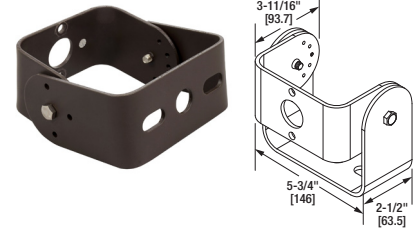
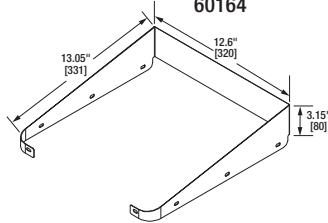
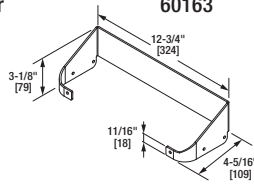

Slip Fitter Mount (71734 or 60651)

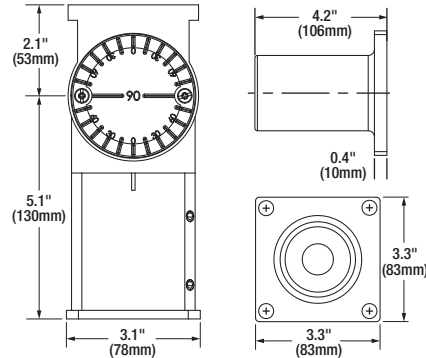

Wall Tenon Mount (60130)

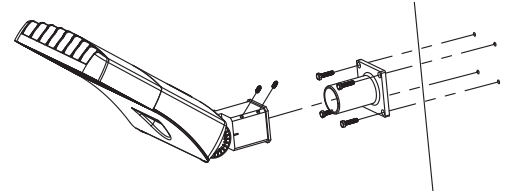

Round Pole Adapter (60128)

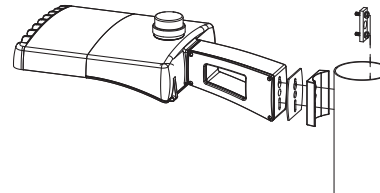
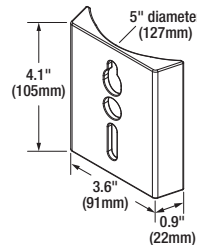

Pole Mount (71733 or 60650)

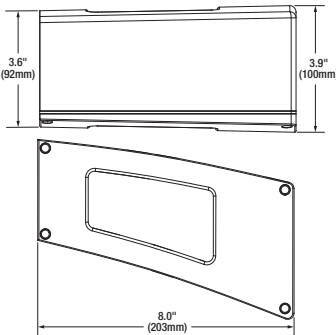

Wall Mount (60129 or 60652)

