

Core & Coil (71A) MH

~LT~ 175W

CORE & COIL HID 71A5492001D

The basic ballast is the open core and coil which is most often used as a component within a lighting luminaire. The core and coil also forms the nucleus of Philips Advance's five other ballast configurations.

Product data

| General Information | |
|------------------------------------|--------------|
| ANSI Code | M102-M142 |
| Lamp Type | 150 MH |
| Number Of Lamps | 1 piece/unit |
| Circuit Type | HX-HPF |
| Ballast Type | Magnetic HID |
| Base Model | 71A5492 |
| Core Size | 3 X 4 (2 LW) |
| Suitable For Outdoor Use | Yes |
| Ignitor Catalog Number | LI533-H4 |
| Ignitor Temperature Rating | 105°C |
| Capacitor Value | 16 MFD |
| Capacitor Catalog Number | 7C160M30RA |
| Capacitor Requirements | 280V |
| Capacitor Temperature Rating | 105°C |
| Capacitor Diameter/Oval Dimensions | 1.65 in |
| Capacitor Height | 2.75 in |
| Automatic Restart | No |

| Operating and Electrical | |
|---------------------------------|---|
| Input Voltage | 120/208/240/277 V |
| Input Frequency | 60 Hz |
| Power (Rated) (Nom) | 150 W |
| Input Current (Open Circuit) | 3.5/2.04/1.73/1.52 A |
| Input Current (Starting) | 1.75/1.3/0.85/0.77 A |
| Input Current (Short Circuit) | 1.03-1.41/0.61-0.92/0.49-0.74/0.44-0.67 A |
| Secondary Short Circuit Current | 2.05-2.55 A |
| Constant Wattage Deviation | 12% |
| Ballast Factor (Nom) | 1 |
| Power Factor (Nom) | 0.90 |
| Open Circuit Voltage | 250 V |
| Input Current (Nom) | 1.6/0.96/0.8/0.7 A A |
| Input Power (Nom) | 185 W |
| Rated Lamp Power | 150W W |
| | |
| Wiring | |
| Wire Striplength | 0.5 mm |
| Wire Length By Color | 12" |
| Wire Type | Stranded |

Core & Coil (71A) MH ~LT~ 175W

| | |
|---|------------|
| Remote Wiring Configuration Allowed | Yes |
| Max Ballast-Lamp Distance Remote Wiring | 10' |
| Recommended Fuse Value | 10/5/5/4 A |

Approval and Application

| | |
|-----------------------------------|------------------------------------|
| Open Circuit Voltage Test (Volts) | 235-290 V |
| Approval Marks | ULR CSA certificate RoHS Compliant |
| Temperature Marking | C/B/B/A |
| UL Recognized | Yes |
| Hipot Test (1 Minute) | 2000 V |
| Hipot Test (2 Seconds) | 2500 V |
| UL Insulation Class | H(180°C) |

| | |
|---------------------|-------|
| UL Temperature Code | 1029C |
|---------------------|-------|

Product Data

| | |
|---------------------------------|-----------------------------|
| Order product name | CORE & COIL HID 71A5492001D |
| EAN/UPC - Product | 781087053249 |
| Order code | 913710606201 |
| Numerator - Quantity Per Pack | 1 |
| Numerator - Packs per outer box | 1 |
| Material Nr. (12NC) | 913710606201 |
| Net Weight (Piece) | 3.502 kg |

Dimensional drawing

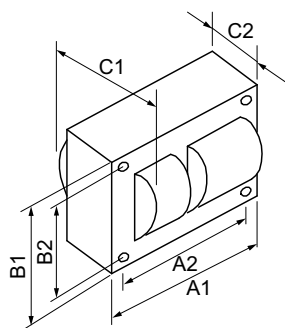

| Product | C1 | C2 | A1 | A2 | B1 | B2 |
|-----------------------------|---------|---------|--------|--------|--------|--------|
| CORE & COIL HID 71A5492001D | 3.90 in | 2.25 in | 3.9 in | 3.5 in | 2.8 in | 2.4 in |

MH BAL 150W M102/142 QUAD KIT

